

# DISNEY'S CORONADO SPRINGS RESORT

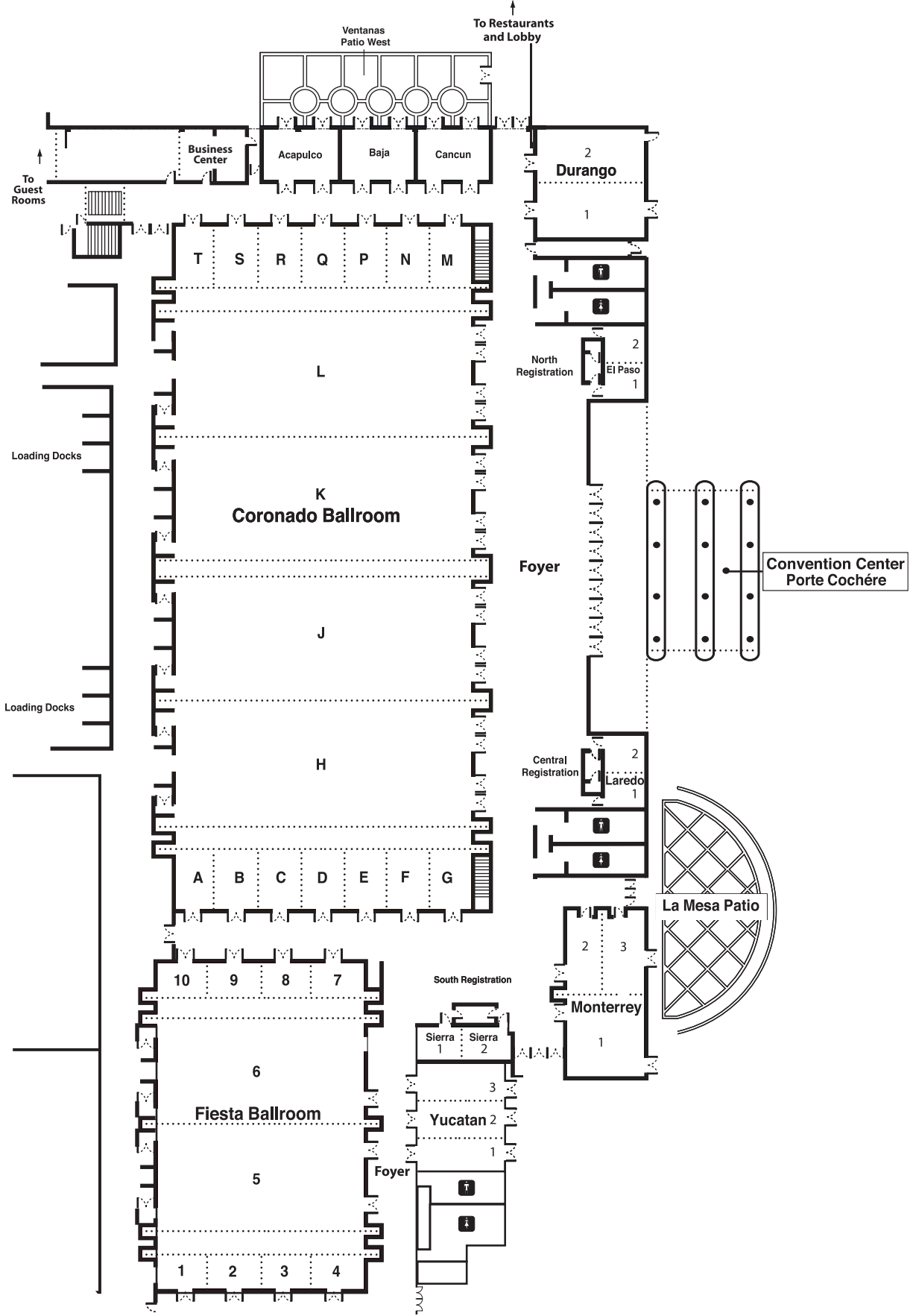

# DISNEY'S CORONADO SPRINGS RESORT

Room Name	Square Feet	Width	Length	Ceiling Height	Theater	School Room	Conference	U-shape	Banquet Rounds of 10	Banquet Rounds of 12	Reception
<b>Meeting Rooms</b>											
Yucatan 1-3	2,850	75	38	16	260	174	70	84	200	240	280
Yucatan 1 & 2	1,900	50	38	16	190	100	40	48	130	156	180
Yucatan 1, 2, 3 (each)	950	25	38	16	80	45	34	40	60	72	80
Sierra 1, 2 (each)	399	19	21	14	28	18	18	18	30	36	30
Sierra 1 & 2	798	38	21	14	56	36	34	36	60	72	72
Monterrey 1	1,600	40	40	16	174	76	30	54	110	132	175
Monterrey 2, 3 (each)	800	20	40	16	70	38	28	30	50	60	75
Monterrey 2 & 3	1,600	40	40	16	160	84	28	48	110	120	130
Monterrey 1-3	3,200	80	40	16	336	168	58	84	210	252	340
Laredo, El Paso 1, 2 (each)	460	23	20	14	44	24	18	18	30	36	40
Laredo, El Paso 1 & 2	920	46	20	14	90	51	34	38	60	72	80
Durango 1, 2 (each)	1,515	•	•	16	166	84	42	54	80	96	150
Durango 1 & 2	3,030	•	•	16	260	171	52	78	160	192	350
Cancun	972	27	36	14	92	54	34	30	60	72	100
Baja	972	27	36	14	92	54	34	30	60	72	100
Acapulco	972	27	36	14	92	54	34	30	60	72	100
Fiesta Ballroom Foyer	•	•	•	•	•	•	•	•	•	•	•
Coronado Ballroom Foyer	•	•	•	•	•	•	•	•	•	•	3,000
<b>Outdoor Patios</b>											
Ventanas West	•	•	•	•	•	•	•	•	•	•	80
La Mesa Patio	3,905	•	•	•	•	•	•	•	240	288	300
Casitas Courtyard	•	•	•	•	•	•	•	•	200	216	400
Cabanas Beach	•	•	•	•	•	•	•	•	850	1,020	1,200

# DISNEY'S CORONADO SPRINGS RESORT

Room Name	Square Feet	Width	Length	Ceiling Height	Theater	School Room	Conference	U-shape	Banquet Rounds of 10	Banquet Rounds of 12	Reception
Coronado Ballroom	60,214	374	161	23	6,684	3,555	2,598	•	4,800	5,700	5,778
Coronado H-L (each)	11,109	69	161	23	1,600	690	•	80	910	1,080	1,119
Coronado H w/Service Hall	13,041	81	161	23	1,610	897	•	•	1,090	1,248	1,224
Coronado L w/Service Hall	13,041	81	161	23	1,610	897	•	•	1,090	1,248	1,224
Coronado A-H	18,515	115	161	23	2,565	984	812	•	1,260	1,512	1,699
Coronado A-J	29,624	184	161	23	4,050	1,881	•	•	2,250	2,700	2,784
Coronado A-G (each)	782	23	34	23	72	42	28	30	60	72	78
Coronado M-T (each)	782	23	34	23	72	42	28	30	60	72	78
Fiesta Ballroom	21,160	184	115	23	2,650	1,428	•	•	1,700	2,040	1,699
Fiesta 5, 6 (each)	6,555	57	115	23	832	408	80	80	560	672	650
Fiesta 5 w/Service Hall	7,935	69	115	23	1,054	543	•	•	630	756	775
Fiesta 6 w/Service Hall	7,935	69	115	23	1,054	543	•	•	630	756	775
Fiesta 1-5	10,580	92	115	23	1,278	560	•	•	850	1,020	1,055
Fiesta 6-10	10,580	92	115	23	1,278	560	•	•	850	1,020	1,055
Fiesta 1-4 (each)	667	23	29	23	64	38	28	30	40	48	67
Fiesta 7-10 (each)	667	23	29	23	64	38	28	30	40	48	67

# VERACRUZ EXHIBIT HALL

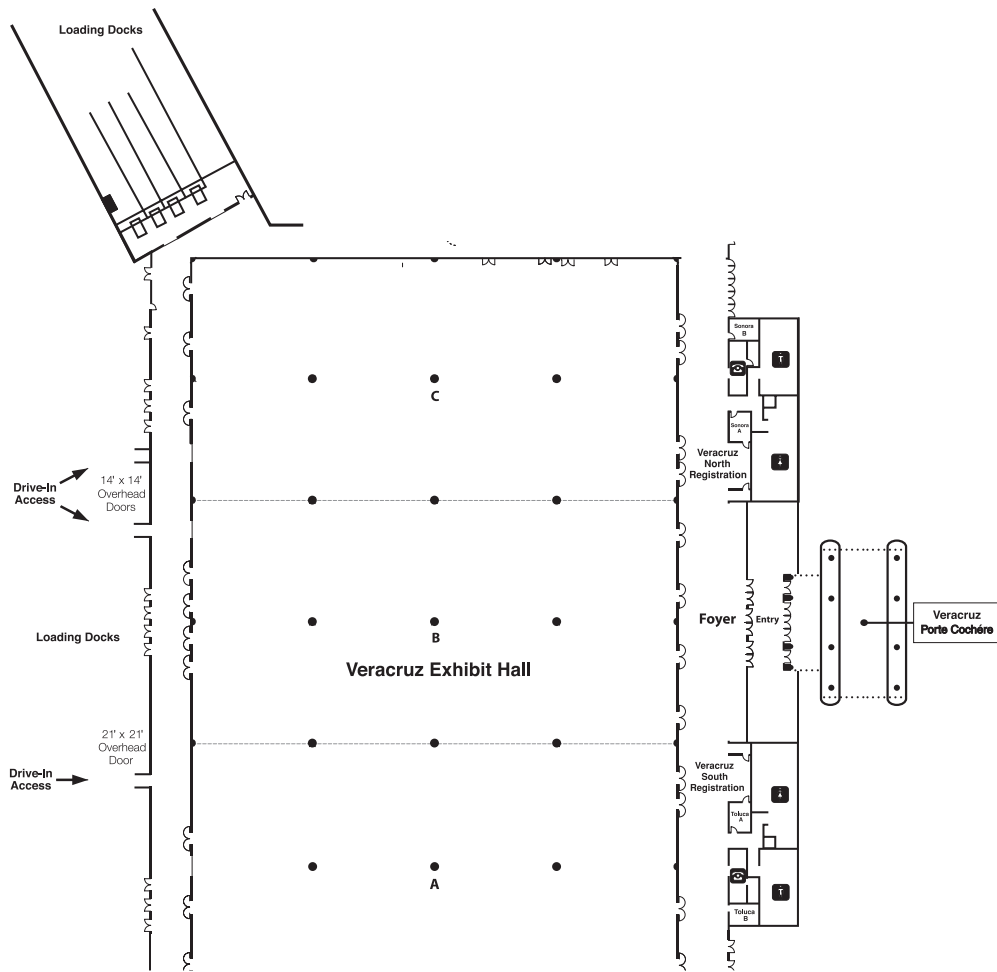

Room Name	Square Feet	Width	Length	Ceiling Height	Theater	School Room	Banquet Rounds of 10	Banquet Rounds of 12	Reception	10' x 10' Exhibit	8' x 10' Exhibit
Veracruz Hall	85,765	362	238	23	5,280	3,720	4,780	5,736	3,700	462	472
Veracruz A	28,322	119	238	23	1,512	1,272	1,080	1,308	1,200	151	160
Veracruz B	29,512	124	238	23	1,750	1,332	1,140	1,368	1,300	166	166
Veracruz C	28,322	119	238	23	1,512	1,232	1,040	1,268	1,200	146	160

### Important Notes:

- Veracruz Exhibit Hall is a carpeted space
- Includes 12 loading docks
- 5 permanent registration desks
- Access to a dedicated marshalling yard
- 10 dedicated meeting planner offices